

BankART 1929

ALL ABOUT BANKART



3C gallery

BankART Studio NYK (Renovated by MIKAN) 1:800

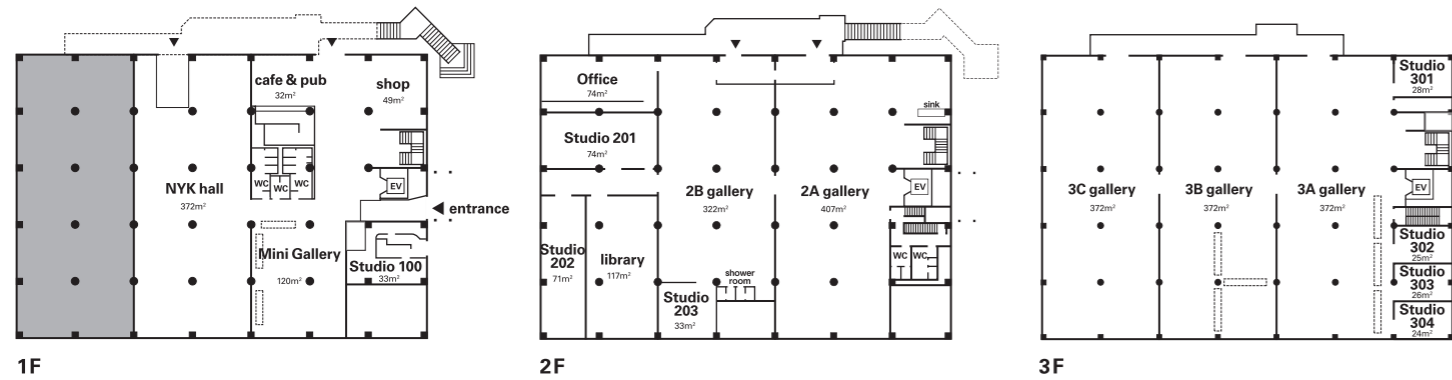

1F

2F

3F



NYK hall

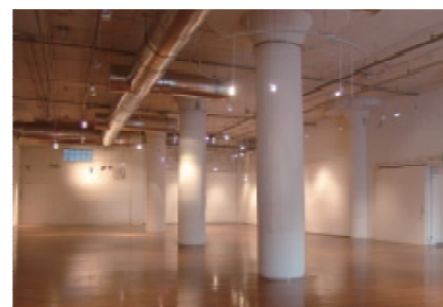

2A gallery

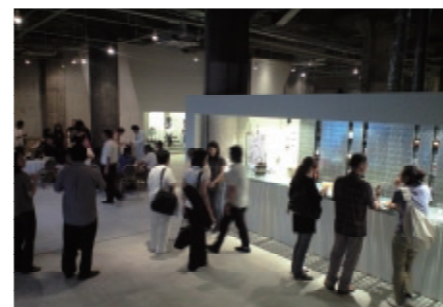

Cafe & Pub

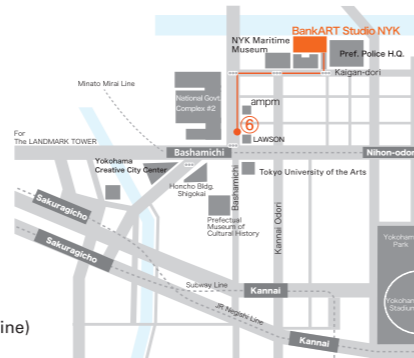

Access

Bashamichi station (Yokohama Minato Mirai Line)
No.6 Exit (Aka-renga Soko guchi) 5min. walk

BankART 1929 Office (BankART Studio NYK)
3-9 Kaigan-dori, Naka-ku, Yokohama 231-0002
Tel : 045-663-2812 Fax : 045-663-2813
info@bankart1929.com



Ever since opening up to foreign trade 150 years ago, Yokohama has been a cultural crossroads. This is to be seen everywhere. From its architectural patrimony, its jazz clubs, its panoply of restaurants, street fashion, Yokohama's culture is richly interwoven. Continuing this tradition, BankART1929, has over the last five years been to the forefront in restoring the city's architectural legacy and revitalising its dock-lands. These areas are now centres for arts and culture, for festivals and various culinary cultures, as well as a meeting ground between private and public, expert and layman. Propositions from abroad have broadened the scope of the facilities there. All About BankART succinctly presents the core of BankART's activities. On the occasion of moving to our new headquarters in BankART Studio NYK in April 2009, we present it to you in its new format. (For details of recent activities, please refer to BankART Life II)

Space

Founded in March 2004, BankART1929 initially worked out of the premises of two former banks. In April, 2005, Tokyo University of the Arts moved into the former Fuji Bank, while the Creative City Centre occupies the former Daiichi bank as of May, 2009. BankART1929 is now based in the fully renovated BankART Studio NYK, (3,000m²). We also administer several offshoot facilities: BankART Sakura-so; BankART Kamome-so; Honcho Experimental Gallery; BankART Vault; BankART Tsumari and so forth.

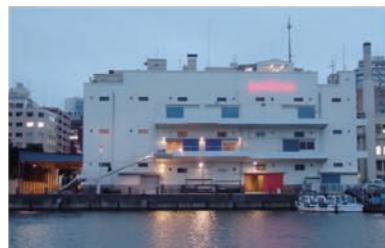

BankART Studio NYK Open 2005.1.15 --



BankART Sakura-so Open 2006.6.30 --



BankART Tsumari Open 2006.7.21 --

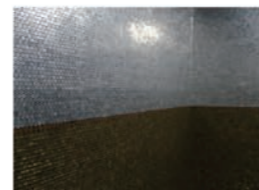

BankART Safe Open 2006.11.18 --



BankART Kamome-so Open 2008.5.7 --

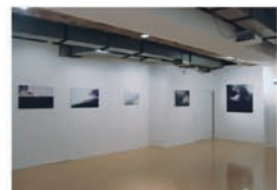

Honcho Experimental Gallery Open 2008.5.7 --



BankART 1929 Bashamichi Open 2004.3.6 -- Close 2004.12.31 Now Tokyo University of the Arts

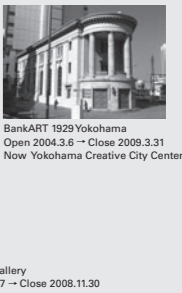

BankART 1929 Yokohama Open 2004.3.6 -- Close 2009.2.31 Now Yokohama Creative City Center



Pio City B2 Gallery Open 2008.5.7 -- Close 2008.11.30

Pub & Cafe

Open daily until 23:00. Not only is this space used for events, but also for the before and after talks during BankART's daily activities, the BankART school and artist in residence programme. It provides an accessible opening to all those not deeply acquainted with art. A drink costs 350 yen. Among its facilities are the outdoors brick kitchen designed by Mikan, the White Limousine Yatai by Atelier Bow-Wow, and Box by Work Station. Opening Hours: Cafe: 11:30 - 17:30 Pub: 17:30 - 23:00



Asako's Bar



Special Ticket A 1000 yen ticket buys you 3 drinks.



Art Beer Brewery Project



White Limousine Yatai by Atelier Wow



KIOSK-YT2005 by Work Station



BankART Ishiyaki Joki Spa by Mikan



BankART 1929 Bashamichi Open 2004.3.6 -- Close 2004.12.31



マナイタ Pub Open 2005.1.15 -- Close 2008.3.31

Shop & Contents

With a catalogue of some 3,500 items, it stocks art-books, DVDs, textbooks and relevant material for the various courses, as well as exhibition catalogues and project outlines. A prize draw featuring works from young artists, galleries and museums from throughout Japan is due to be held. Catalogues and DVDs are not only available during exhibitions, but will also be made widely available. Moreover, some 40 publications, including those on subjects not directly linked to BankART, have been published to date.



BankART Life A4 254p ¥1,600



BankART Life II A4 288p ¥2,000



Creative City Yokohama: Past and Future A5 192p ¥1,260



Designing Future Society: Yokohama's Environmental Space Planning A5 192p ¥1,260

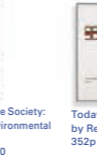

Today's Art Frontiers by Ren Fukuzumi 352p ¥2,100

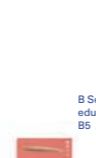

B Semi The History of new educational Methods for the Arts B5 288p ¥2,400



Yokohama Conference 2004: Why an International Exhibition? A5 254p ¥1,200

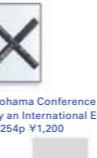

Kazuo Ohno Photo Album A5 64p ¥800

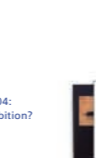

Kazuo Ohno and Tatsumi Hijikata in the 1960s A5 48p ¥630



Kazuo Ohno Centenary A5 64p ¥800



Let's go to Noge! 6 posters



Portfolio Series: BankART Bank Under 35 A4 16p ¥150



Kimura Takahto (A Cook who delivers to your Doorstep) DVD ¥500



YOKOHAMA Onu-ning for BankART Life) CD ¥500



ARICA (Interview+kawase) DVD ¥2,500



Mitsuki Murata (no comment) DVD ¥1,500



Isotobuki DVD ¥500



Monju no Chienetsu's Amazing History DVD ¥2,500

Price includes tax

BankART school

Based on a system of 8 bimonthly classes, it runs from Monday to Saturday, with up to 20 students per class. Founded on the idea of a temple school, BankART school offers a lifelong course of lectures, as well as post-graduate courses. With 160 courses, a staff of 465 (guests included) and some 2,400 students enrolled, it serves as a meeting for students and teachers alike. One of the course's contents is published in a free paper 'HAMART'.



Artist in Residence

8 studios available, varying between 20 and 80m² in size, for a 2 month period. A welcome party as well as an open-studio day is arranged for the invited artists so that the public can become acquainted with them. In addition to an overseas exchange programs, collaborative initiatives with regional universities also take place.



Artist Exchange Program

Entrepreneurial Activities

The idea is both to modernise and diffuse Yokohama's potential. With such wide ranging themes as architectural legacy, cuisine, fashion, photography, scenic arts (notably Kazuo Ohno), and street life, Yokohama possesses a myriad of resources. An increasing number of comprehensive large-scale international exhibitions, similar to those at BankART Life II are now being held.



Food and Contemporary Art, part 2



BankART Life



Kazuo Ohno Festival 2006



Japan-France Contemporary Arts Exchange Exhibition



Earthquake Disaster Prevention Exhibition



Tulip Flow Project



Landmark Project II



On Route 16



BankART Life II



Rooftop Paradise

Co-ordinating Office

Of the 1200 offers in a year, some 400 come to fruition. BankART's fundamental policy is easy access and thorough completion. BankART is not merely a leasing agent, it also invests itself so that every project realises its full potential. A 350m² block costs 60,000 yen per day, with a 50% reduction on a weekly basis. Depending on content, tax reductions are applicable. In many cases, BankART collaborates on planning and budget estimates.



GLOBAL PLAYERS



KATHY+graf (Merry Go Round in Flames)



Takeru Ujino (Ujino and the Rotators)



LIVE! no media 2006 Grass Field Edition



A Dialogue with the City



the GROUND-breaking 2006 Natsuko Tezuka and Hoho-Do

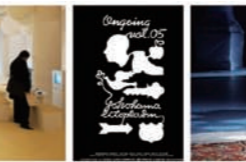

Electrical Fantasia



Ongoing Vol.5



Shintai Hyogen Circle 'Troubling Boy'



Emotional Theft



Off Nibroll Public-un+public Vol.2 in ASIA



HARLEY THE HISTORY

Networks

When BankART started up in 2004 it was quite isolated but has recently developed a solid working network. Along with those directly connected with BankART, this network is comprised of institutions heavily promoted by the municipal government. The term 'new inner city community', or 'neighbourhood' has an understandable ring about it, and suggests enjoyment. While by no means overly familiar, it isn't unusual to find people borrowing computers, sharing ideas, or renting a room there.



Honcho Building 45



Creative Space 9001



Kogane-X lab.



Tokyo University of Arts, Yokohama Campus

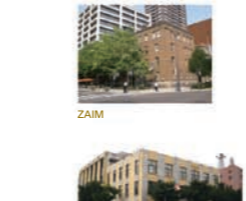

TAV(Taipei)



Yokohama Triennale (above) Ticket for 2008 (below) Banner



5 Harbour Cities: 'In Search of a Modern Boy and a Modern Girl'



Let's Get Together! Artists' Network



Mobile BankART School



Kitanaka BRICK & Kitanaka WHITE Jun.2005 - Oct.2006